

banks

with Installation Instructions
Owner's Manual

Banks Monster[®] Exhaust System

2010-2012 Volkswagen Golf 4 Door TDI 2.0L Clean Diesel

THIS MANUAL IS FOR USE WITH SYSTEMS 46170

Gale Banks Engineering
546 Duggan Avenue • Azusa, CA 91702
(626) 969-9600 • Fax (626) 334-1743

Product Information & Sales: (888) 635-4565
Customer Support: (888) 839-5600
Installation Support: (888) 839-2700

bankspower.com

banks

General Installation Practices

Dear Customer,

If you have any questions concerning the installation of your Banks Power System, please call our Technical Service Hotline at (888) 839-2700 between 7:00 am and 5:00 pm (PT). If you have any questions relating to shipping or billing, please contact our Customer Service Department at (888) 839-5600.

Thank you.

- 1.** Before starting work, familiarize yourself with the installation procedure by reading all of the instructions.
- 2.** The exploded view provides only general guidance. Refer to each step and section diagram in this manual for proper instruction.
- 3.** Throughout this manual, the left side of the vehicle refers to the driver's side, and the right side to the passenger's side.
- 4.** Disconnect the negative (ground) cable from the battery (or batteries, if there are two) before beginning work.
- 5.** Route and tie wires and hoses a minimum of 6" away from exhaust heat, moving parts, and sharp edges. Clearance of 8" or more is recommended where possible.
- 6.** When raising the vehicle, support it on properly weight-rated safety stands, ramps or a commercial hoist. Follow the manufacturer's safety precautions. Take care to balance the vehicle to prevent it from slipping or falling. When using ramps, be sure the front wheels are centered squarely on

the topsides. When raising the front of the vehicle, put the transmission in park (automatic) or reverse (manual), set the parking brake, and block the rear wheels. When raising the back of the vehicle, be sure the vehicle is on level ground and the front wheels are blocked securely.

CAUTION! Do not use floor jacks to support the vehicle while working under it. Do not raise the vehicle onto concrete blocks, masonry or any other item not intended specifically for this use.

7. During installation, keep the work area clean. Do not allow anything to be dropped into intake, exhaust, or lubrication system components while performing the installation, as foreign objects will cause immediate engine damage upon start-up.

Tools Required:

- 1/2" and 3/8" drive ratchets with inch and metric sockets and 1/2" and 3/8" drive extension
- Inch and metric combination or open-end wrenches
- Standard screwdriver
- Clean shop towels or rags
- Pry-bar
- Reciprocating saw

Highly recommended tools and supplies:

- Foot-pound torque wrenches
- Penetrating oil or light lubricant spray
- Oxy-acetylene torch

General Assembly Diagram

Figure 1

Item	Description	P/N	Qty.
1	Exhaust Clamp, 2 1/4"	52459	1
2	Intermediate Pipe	53860	1
3	Tailpipe	53861	1
4	Band Clamp, 3"	52466	1
5	Support Hanger	53862	1
6	Hex Bolt, 5/16" -18 X 1 1/4"	91232	2
7	Washer, 5/16"	91202	4
8	Nut, Crimplock - 5/16" -18	91212	2
9	Rubber Grommet	53732	1
10	Urocal, Bank Power	96009	2

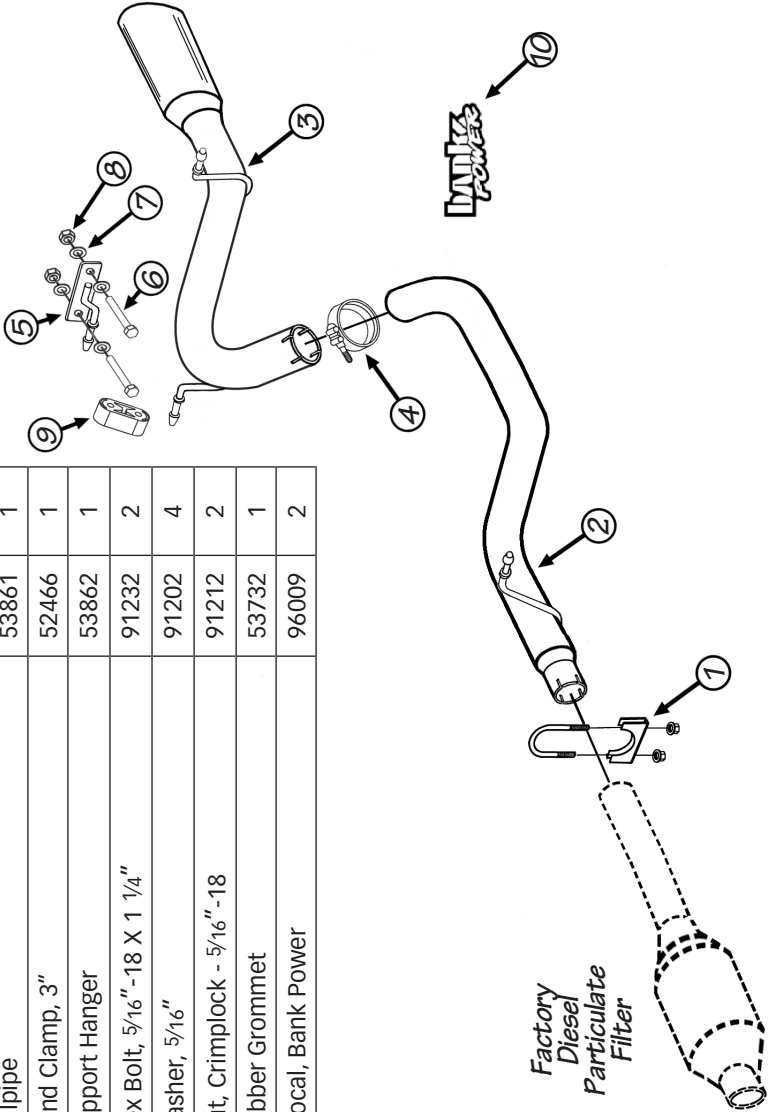

Monster Exhaust System Installation

1. As a precaution, disconnect the ground of the battery (if there is more than one battery, disconnect both).

2. Raise the vehicle and support it with properly weight rated safety stands, ramps or a commercial hoist. Follow the manufacturer's safety precautions. Take care to balance the vehicle to prevent it from slipping or falling. When using ramps, be sure the front wheels are centered squarely on the topsides; place the transmission in park; set the parking brake and place blocks behind the rear wheels.

CAUTION: DO NOT WORK UNDER ANY VEHICLE SUPPORTED ONLY BY A JACK. SEVERE INJURY MAY RESULT.

WARNING! The following step may require the use of a torch and/or saw. Proper safety equipment should be used. Failure to use proper safety equipment may result in severe injury.

3. Starting at the rear of the vehicle, loosen and disconnect the tailpipe muffler assembly from the intermediate pipe by cutting through the connection or by removing the clamp and heating the joints with an oxy-acetylene torch to allow crimped pipe to separate. Remove the tailpipe muffler assembly by disengaging the exhaust system hanger pins from the rubber hangers using a large screwdriver or pry bar.

NOTE: Lubricating the rubber hangers with WD-40 or similar lubricant will ease removal of the hanger pins.

4. Remove the clamps holding the intermediate pipe to the Diesel Particulate Filter. Separate the intermediate pipe from the Diesel Particulate Filter. Remove the intermediate pipe hanger pins from

the rubber hangers with a pry bar (Spray lubricant will ease hanger removal) and remove the intermediate pipe assembly from the vehicle.

NOTE: Use of an oxy-acetylene torch may be necessary.

CAUTION: DO NOT CUT OR DAMAGE DIESEL PARTICULATE FILTER TUBING DURING THE REMOVAL PROCESS.

5. Locate the supplied support hanger bracket and install onto the center of the rear axle so that the hanger pin points to the passenger side of the vehicle. Secure in place with the supplied 5/16" Hex bolts, washers, and lock nuts and torque the hardware to 48ft-lbs. See **Figure 2**.

6. Locate the supplied Rubber hanger and install onto the support bracket.

7. Install the 2 1/4" exhaust clamp onto the front of the Banks intermediate pipe. Install the intermediate pipe onto the Diesel Particulate Filter outlet. Insert the hanger pin on the intermediate pipe into the factory rubber hanger. Loosely snug the 2 1/4" clamp. Position the rubber hanger as shown in **Figure 3**.

8. Slide a supplied 3" band clamp onto the Tailpipe inlet. Install the tailpipe onto the intermediate pipe. Insert the front hanger pin into the installed banks rubber hanger and the rear hanger pin into the factory rubber hanger. Loosely snug the 3" band clamp. Position the rubber hanger as shown in **Figure 2**.

9. With everything positioned properly, begin to tighten the clamps starting with the ones closest to the front of the vehicle and working your way back. Evenly torque the exhaust clamps to 35 ft-lbs. Make sure that each slip is fully inserted (+/- 1/4 inch).

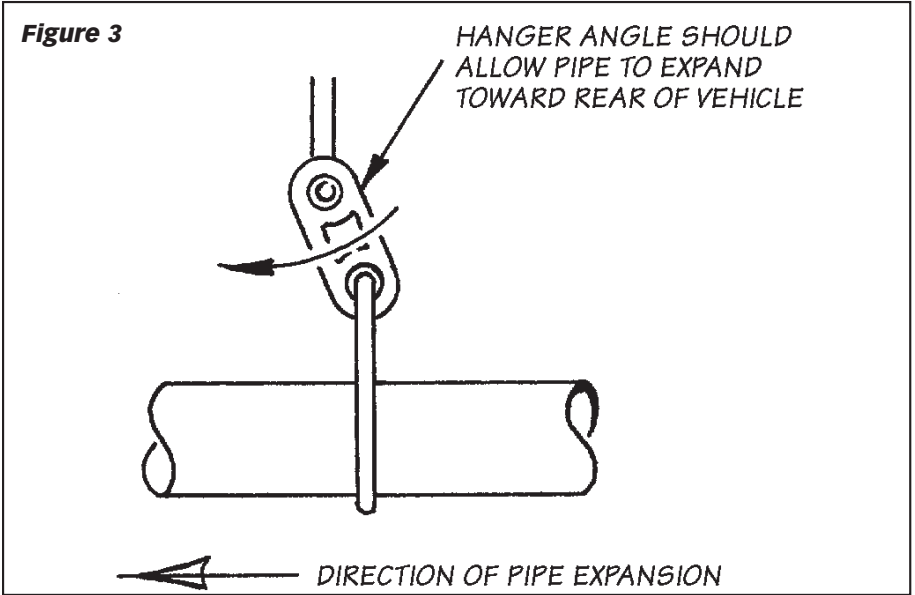
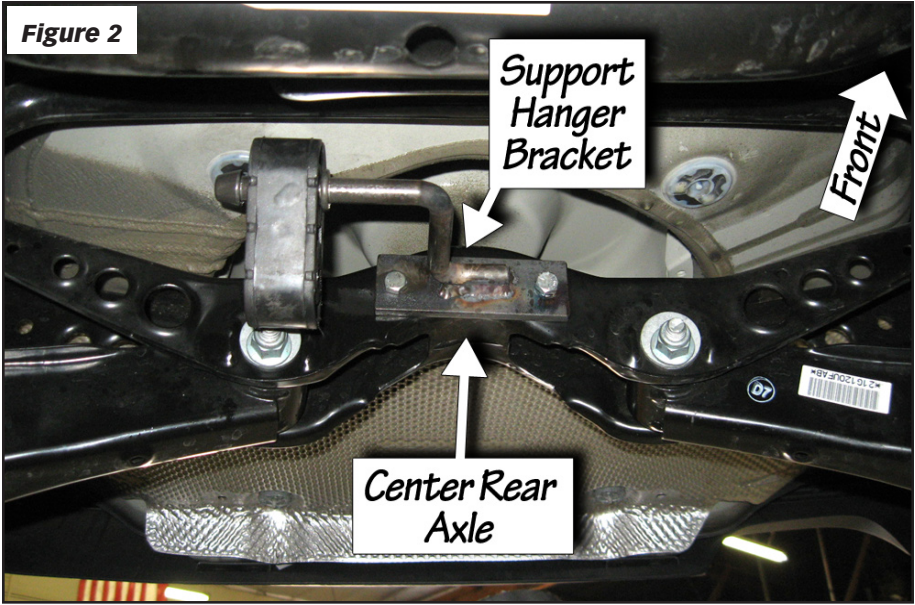

10. Remove the protective covering from the tailpipe tip.

CAUTION: THE PROTECTIVE COVERING MAY IGNITE AND BURN IF NOT REMOVED PRIOR TO RUNNING THE ENGINE.

11. Your system includes two “Banks Power” logos. Position the logos for a clean factory look.

12. Re-connect battery terminals if previously removed. Banks Monster Exhaust installation is now complete.

Notes

Gale Banks Engineering
546 Duggan Avenue • Azusa, CA 91702
(626) 969-9600 • Fax (626) 334-1743

Product Information & Sales: (888) 635-4565
Customer Support: (888) 839-5600
Installation Support: (888) 839-2700

bankspower.com